

THIS PLAT PREPARED AT THE REQUEST OF

**BPB PROPERTIES, LLC**

A DIVISION OF TAX MAP # 072-00-04-005,  
& TAX MAP # 072-00-00-004,  
IN AND NEAR THE TOWN OF SCOTIA,  
HAMPTON COUNTY, SOUTH CAROLINA

TOTAL AREA  
198.27 acres

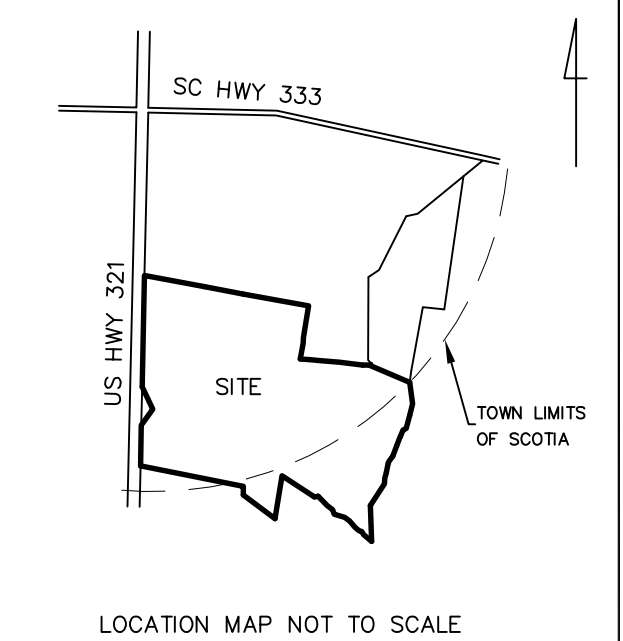

- LEGEND:
- CMF - CONCRETE FOUND
  - CMS - CONCRETE SET
  - RBS - 3/4" REBAR SET
  - RBF - REBAR FOUND
  - IPF - IRON PIPE FOUND
  - TP - TELEPHONE PEDESTAL
  - OPL - OVERHEAD POWER
  - NTS - NOT TO SCALE
  - R/W - RIGHT OF WAY
  - TM - TAX MAP
  - PB - PLAT BOOK
  - DB - DEED BOOK
  - POB - POINT OF BEGINNING
  - X - SPOT ELEVATION
  - C/L - CENTERLINE
  - Q - POWER POLE
  - OML - OLD MARKED LINE

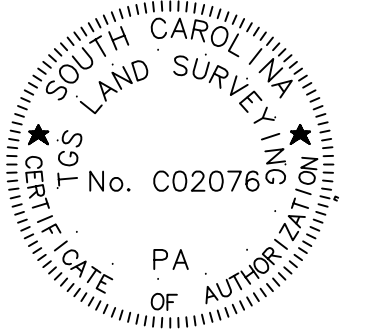

LINE TABLE

LINE	LENGTH	BEARING
L1	85.73	N03°43'53"E
L2	221.33	N10°56'43"E
L3	132.99	N86°18'57"W
L4	135.07	N84°33'31"W
L5	279.27	N85°06'31"W
L6	322.93	N82°52'41"W
L7	90.64	S88°27'59"W
L8	48.00	S66°24'39"W
L9	36.97	S57°39'37"E
L10	42.79	S40°34'08"E
L11	166.34	S08°57'36"W
L12	297.96	N07°41'25"W
L13	167.68	N13°11'15"E
L14	186.92	N15°26'55"E
L15	49.00	N64°22'15"E
L16	97.39	S21°38'55"W
L17	7.11	S88°45'47"E
L18	21.04	S21°38'55"W
L19	120.62	N21°04'35"E
L20	8.73	S58°46'28"E
L21	151.74	S21°04'35"W
L22	89.61	N36°42'35"E
L23	29.08	N18°32'35"E
L24	37.66	N09°20'32"E
L25	93.51	N13°16'57"E
L26	81.70	N14°05'47"E
L27	77.00	N05°09'07"E
L28	145.16	S49°55'33"E
L29	53.01	S32°23'38"E
L30	37.59	S77°47'48"E
L31	73.98	S49°57'38"E
L32	118.43	S40°08'03"E
L33	82.38	S53°30'28"E
L34	150.95	S72°34'38"E
L35	65.64	S21°59'28"E
L36	92.17	S52°31'43"E
L37	181.62	S44°39'48"E
L38	52.53	N81°58'21"E
L39	120.24	N00°49'12"W

- TM#072-00-03-002  
A N/F ESTATE OF ANNIE BOSTICK  
DB 25 PG 340
- TM#072-00-03-004  
B N/F ESTATE OF OLLIE SPEAKS
- TM#072-00-03-005  
C N/F OLIVER SPEAKS JR. & BEAULAH M. SPEAKS  
DB 65 PG 670
- TM#072-00-03-006  
D N/F ABILINE B. HOUSEY, ETAL  
PB 12 PG 149  
DB 414 PG 307
- TM#072-00-03-007  
E N/F BARBARA M. POLITE  
PB 12 PG 149  
DB 409 PG 88
- TM#072-00-03-008  
F N/F BERNIS PEEPLES  
DB 411 PG 280
- TM#072-00-03-009  
G N/F WINFIELD HOUSEY  
DB 448 PG 21
- TM#072-00-04-002  
H N/F ESTATE OF GUSSIE WILSON JR  
PLAT CAB A-5-6  
DB 218 PG 42
- TM#072-00-04-003  
I N/F MARY F. PATTERSON & JOHN PATTERSON  
PB 14 PG 153  
DB 368 PG 38
- TM#072-00-00-001  
J N/F ESTATE OF GUSSIE WILSON JR  
DB 218 PG 42  
PLAT CAB A-5-6
- TM#053-00-02-023  
K N/F KATE WILSON ESTATE

- REFERENCE
1. PLAT BOOK 13 PAGE 143
  2. DEED 419 PAGE 122
  3. PLAT BOOK 6 PAGE 167
  4. DEED BOOK 419 PAGE 122
  5. PLAT BOOK 9 PAGE 80
  6. PLAT CABINET A-65-4
  7. PLAT BOOK 186 PAGE 3

BY GRAPHICAL DETERMINATION  
NOTE: This Lot Appears To Lie In A Federal Flood Plain  
Zones X & A Minimum Required Elevation n/a & un-numbered Ft. NAVD88  
FIRM #45049C0375C 09/29/2010

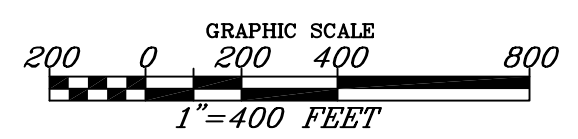

I HEREBY STATE TO THE BEST OF MY KNOWLEDGE, INFORMATION & BELIEF, THE SURVEY SHOWN HEREON WAS MADE IN ACCORDANCE WITH THE REQUIREMENTS OF THE MINIMUM STANDARDS MANUAL FOR THE PRACTICE OF LAND SURVEYING IN SOUTH CAROLINA, AND MEETS OR EXCEEDS THE REQUIREMENTS FOR A CLASS C SURVEY AS SPECIFIED THEREIN. ALSO THERE ARE NO VISIBLE ENCROACHMENTS OR PROJECTIONS OTHER THAN SHOWN.

JOB # 17050B-23  
DATE: DECEMBER 31, 2019

TGS LAND SURVEYING  
P.O. BOX 2023  
RIDGELAND, S.C. 29936  
Phone 843-726-9117

THOMAS G. STANLEY, JR., PLS # 18269